

# Model 3510

## Shear Beam Load Cells



### Features

- Capacities: 500 - 5000 kg (1102-11022 lbs)
- Stainless steel construction
- Combined error only 0.02%
- Hermetically sealed to IP68
- 6 Wire (sense) circuit
- Interchangeable with Model 3410 and other
- Industry standard configuration load cells
- Fully welded protection
- Hostile environment capability

Model 3510 is a hermetically sealed, stainless steel shear beam. Designed for the ultimate protection necessary for today's hostile environments, it is ideally suited for low profile platforms, pallet truck weighers, tanks and silos.

This high accuracy load cell is hermetically sealed to IP 68 and is OIML Class C3 Approved. When operated at constant temperature, all load cells offer 0.02% combined error performance regardless of accuracy class.

Hermetically sealed, stainless steel construction assures long-term stability even under harsh environment and extreme temperatures. The slotted profile enables manufacturers to easily position the load cell without resorting to the use of mounting plates.

For tank or hopper mounting applications, Tedea-Huntleigh offers the Model 9100 Series Cell-Mates. Cell-Mates simplify mounting while increasing system accuracy.



#### Contact Info

E-mail  
sales@[tedea-huntleigh.com](mailto:sales@tedea-huntleigh.com)  
Website  
[www.tedea-huntleigh.com](http://www.tedea-huntleigh.com)

**Europe**  
Tedea-Huntleigh Europe  
Ltd.  
37 Portmanmoor Road  
Cardiff  
CF24 SHE  
United Kingdom  
Tel: +44(0)29-20460231  
Fax: +44(0)29-20462173

**International**  
Tedea-Huntleigh International  
Ltd.  
5 Hozoran St.  
New Industrial Zone  
P.O. Box 8381, Netanya 42506  
Israel  
Tel: +972-9-863-8888  
Fax: +972-9-863-8800

**China**  
Beijing Tedea-Huntleigh  
No. 16 Hong Da Bei Lu  
Da Xing County, Beijing Eco-  
nomic & Technology Develop-  
ment Area.  
Beijing 100176  
Tel: +86-10-67881604-09  
Fax: +86-10-67881576

**Germany**  
Tedea-Huntleigh GmbH.  
Mumlingweg 18  
D-64297  
Darmstadt-Eberstadt  
Germany  
Tel: +49-6151-94460  
Fax: +49-6151-944640

**France**  
SEEA sa  
16 Rue Francis Vovelle  
28000 Chartres  
France  
Tel: +33-237-33-3120  
Fax: +33-237-3129

20630 PLUMMER ST  
CHATSWORTH CA 91311  
USA

TEL: 800.626.2616  
FAX: 818.701.2799

# Model 3510

# Shear Beam Load Cells

| GRADE  | E   | G/C3   | UNITS                   |
|--|---|--------|-------------------------|
| Rated Capacity   | 500, 1000, 2000, 5000   |        | kg                      |
| Rated Output*  | 2.0 ± 0.25%   |        | mV/V                    |
| Total Error  | 0.05  | 0.02   | ±% of Rated Output      |
| Creep at Rated Capacity / Zero Return After 30 Minutes | 0.05  | 0.017  | ±% of Applied Load      |
| Zero Balance   | 3   | 2      | ±% of Rated Output      |
| Temperature Range: Safe                                | -30 to +80  |        | °C                      |
| Temperature Range: Compensated                         | -10 to +40  |        | °C                      |
| Temperature Effect: On Output                          | 0.004   | 0.0012 | ±% of Applied Load / °C |
| Temperature Effect: On Zero                            | 0.007   | 0.0023 | ±% of Rated Output / °C |
| Maximum Overload at the Center Loading Point           | 150   |        | % of R.C.               |
| Ultimate Overload at the Center Loading Point          | 300   |        | % of R.C.               |
| Excitation: Recommended                                | 10  |        | VDC or Vac rms          |
| Excitation: Maximum                                    | 15  |        | VDC or Vac rms          |
| Input Impedance  | 420 ± 20  |        | Ohms                    |
| Output Impedance                                       | 350 ± 3   |        | Ohms                    |
| Insulation Resistance                                  | >1000   |        | Mega Ohms               |
| Weight: 500 - 2000 kg                                  | 0.90  |        | kg                      |
| Weight: 5000 kg  | 1.90  |        | kg                      |
| Construction   | Stainless Steel   |        |                         |
| Cable  | 5 Meters (Standard), 6 Wire Polyurethane Jacket, Dual Floating Screen |        |                         |
| Environmental Protection                               | IP67  |        |                         |

\*All accuracy specifications maintained when 150% of nominal load is applied for 3 mV/V output.

## Wiring Schematic Diagram

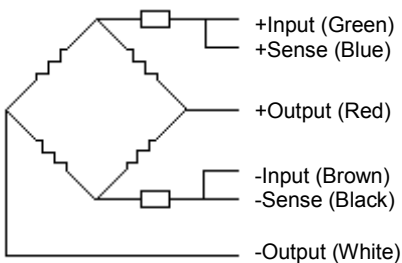

The two "sense" wires sample the bridge supply voltage at the load cell. Complete compensation of change in the lead wire resistance, due to temperature change and/or cable extension, is achieved by feeding this voltage into appropriate electronics.

## Outline Dimensions All Capacities (in inches unless otherwise specified.)

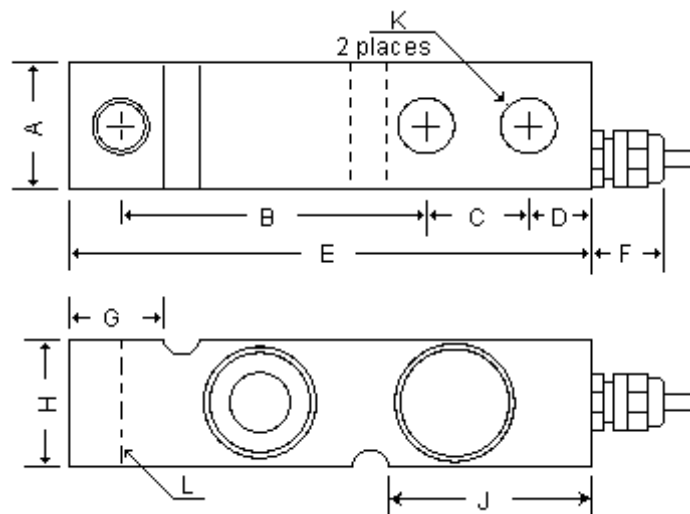

| Capacity      | A    | B    | C    | D    | E    | F    | G    | H    | J    | K       | L           |            |
|---------------|------|------|------|------|------|------|------|------|------|---------|-------------|------------|
| 500 - 2000 kg | 1.26 | 3.00 | 1.00 | 0.62 | 5.12 | 0.71 | 0.93 | 1.26 | 1.99 | 13.5 mm | 1/2"-20 UNF | M12 X 1.75 |
| 5000 kg       | 1.44 | 3.75 | 1.50 | 0.75 | 6.75 | 0.71 | 1.46 | 1.89 | 2.76 | 20.5 mm | M20x2.5     | 20.5 mm    |