

Model 1130

Single Point Load Cells

NEW!

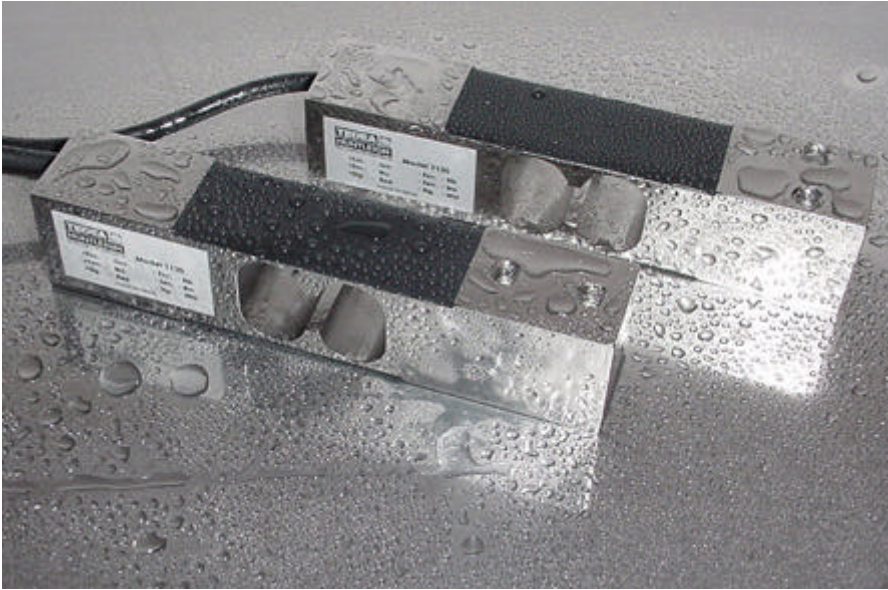

Features

- Capacities: 7.5 kg to 100 kg
- Stainless steel construction
- 6 wire (sense circuit)
- Single point 400 mm x 400 mm platform
- IP66 protection
- Factory Mutual approved
- NTEP approved to 4000 divisions
- OIML approved to 6000 divisions (7.5 kg -35 kg capacities)
- OIML Approved to 3000 divisions (50 kg -75 kg capacities)
- Available in an M6 x 1.0 thread

Model 1130 is a low profile single point load cell designed for direct mounting of low cost weighing platforms.

The small physical size combined with high accuracy and low cost, makes this load cell ideally suited for low profile bench and counting scales or other weighing applications which are subject to harsh treatment and/or caustic environments. Environmental protection to IP66 is provided as standard.

Construction in stainless steel, this high accuracy load cell is approved to OIML, NTEP and Factory Mutual and other stringent approval standards.

The two additional sense wires feed back the excitation voltage reaching the load cell. Complete compensation of changes in lead resistance due to temperature changes and/or cable length changes, is achieved by feeding this voltage into the appropriate electronics.

Europe
Tedeo-Huntleigh
Europe Ltd.
37 Portmanmoor
Road
Cardiff
CF24 SHE

International
Tedeo-Huntleigh Inter-
national Ltd.
5 Hozoran St.
New Industrial Zone
P.O. Box 8381, Netanya
42506

China
Beijing Tedeo-Huntleigh
No. 16 Hong Da Bei Lu
Da Xing County, Beijing
Economic & Technology
Development Area,
Beijing 100176

Germany
Tedeo-Huntleigh
GmbH.
Mumlingweg 18
D-64297
Darmstadt-
Eberstadt

France
SEEA sa
16 Rue Francis
Vovelle
28000 Chartres
France



EXCELLENCE IN LOAD CELLS

Contact Info

E-mail
sales@tedea-huntleigh.com
Website
www.tedeo-huntleigh.com

20630 PLUMMER STREET
CHATSWORTH, CA 91311
USA

TEL: 800.626.2616
FAX: 818.701.2799

Model 1130

Single Point Load Cells

Parameters	Value			Unit
OIML Accuracy Class	6000		3000	divisions
OIML Rated Capacity - R.C.	7.5 - 35		50 - 75	kg
OIML Certificate number	TC5703 rev 2			
T-H Accuracy Class	E	G	H	
NTEP Accuracy Class / nmax, Single Cell		III/3000	III/4000	
NTEP Rated Capacity - R.C.	7.5 - 60			kg
NTEP Certificate number	00-082			
Rated Capacity - R.C.	7.5, 10, 15, 20, 30, 50, 75, 100			kg
Rated Output - R.O.	2			mV/V
Rated Output tolerance	0.2			+ - mV/V
Total Error	0.03	0.02	0.015	+ - % of Rated Output
Creep & Zero Return	0.05	0.017	0.026	+ - % of Applied Load
Temperature effect on zero	0.01	0.004	0.003	+ - % of Rated Output /°C
Temperature effect on output	0.003	0.001	0.00075	+ - % of Applied Load/°C
Eccentric loading error	0.007	0.0049	0.0035	+ - % of load/cm
Zero balance	0.2			+ - mV/V
Maximum platform size	40x40			cm
Temperature Range: Compensated	-10 to +40			°C
Temperature Range: Safe	-20 to +70			°C
Maximum safe static overload	150			% of R.C.
Ultimate static overload	300			% of R.C.
Excitation: Recommended	10			Vdc or Vac
Excitation: Maximum	15			Vdc or Vac
Input impedance	383+-15			Ohms
Output impedance	350+-5			Ohms
Insulation resistance	>2000			MegaOhms
Cable Length	1.5			M
Cable Type	6 conductors, 26 AWG, shielded, PVC jacket			
Construction	Stainless Steel			
Compensation circuit type	Balanced			
Environmental protection	IP66			
Approvals	NTEP (4000 divisions), OIML (3000 divisions in 7.5 kg - 75 kg capacities), Factory Mutual			
Outline Dimensions Dwg.	196.000.00-4			

Wiring Schematic Diagram

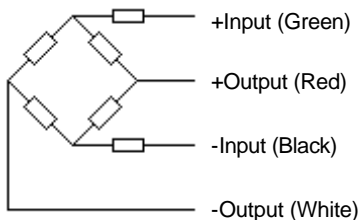

Optional

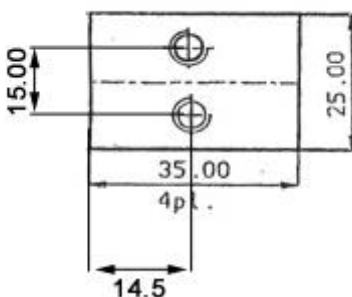

Outline Dimensions All Capacities (in mm)

